

TECSEDO® PANELS - HARDWARE COMPONENTS BY

Hinges TECSEDO®SAFE Micro

- **59.8Z** SIDE HINGE WITH ROLLER CARRIER INT.45MM WITH RIVET COVER - GALVANIZED
- **59.8VB** SIDE HINGE WITH ROLLER CARRIER INT.45MM WITH RIVET COVER - RAL9016
- **23.6Z** SIDE HINGE TANDEM ROLLER WITH RIVET COVER 65X91X2 GALVANIZED
- **23.6VB** SIDE HINGE TANDEM ROLLER WITH RIVET COVER 65X91X2 RAL9016
- **24.2Z** INTERMEDIATE HINGE Dist.45MM 84X65X2MM WITH RIVET COVER GALVANIZED
- **24.2VB** INTERMEDIATE HINGE Dist.45MM 84X65X2MM WITH RIVET COVER RAL9016

Hinges TECSEDO®BASE Micro

- **59.4Z** TOP ROLLER CARRIER SET 106X73X63MM Dist.40MM GALVANIZED
- **59.4VB** TOP ROLLER CARRIER SET 106X73X63MM Dist.40MM RAL9016
- **24.10Z** INTERMEDIATE IND. HINGE Dist.40MM 67X64X2MM GALVANIZED
- **24.10VB** INTERMEDIATE IND. HINGE Dist.40MM 67X64X2MM RAL9016

End Cap TECSEDO®SAFE Micro

- **53.3DXP** END CAP DRILLED (R) W.67,5 L=480 FINGER SAF. SHAPE RAL9016
- **53.3SXP** END CAP DRILLED (L) W.67,5 L=480 FINGER SAF. SHAPE RAL9016
- **53.13DXP** END CAP DRILLED (R) W.67,5 L=590 FINGER SAF. SHAPE RAL9016
- **53.13SXP** END CAP DRILLED (L) W.67,5 L=590 FINGER SAF. SHAPE RAL9016
- **53.33DXP** END CAP DRILLED (R) W.67,5 L=900 FINGER SAF. SHAPE RAL9016
- **53.33SXP** END CAP DRILLED (L) W.67,5 L=900 FINGER SAF. SHAPE RAL9016
- **53.1DXAZ** END CAP DRILLED (R) W.67,5 L=480 FINGER SAF. SHAPE GALVANIZED
- **53.1SXAZ** END CAP DRILLED (L) W.67,5 L=480 FINGER SAF. SHAPE GALVANIZED
- **53.10DXAZ** END CAP DRILLED (R) W.67,5 L=590 FINGER SAF. SHAPE GALVANIZED
- **53.10SXAZ** END CAP DRILLED (L) W.67,5 L=590 FINGER SAF. SHAPE GALVANIZED
- **53.23DXP** END CAP DRILLED (R) W.137,5 L=590 FINGER SAF. SHAPE RAL9016
- **53.23SXP** END CAP DRILLED (L) W.137,5 L=590 FINGER SAF. SHAPE RAL9016
- **53.23DXZ** END CAP DRILLED (R) W.137,5 L=590 FINGER SAF. SHAPE RAW
- **53.23SXZ** END CAP DRILLED (L) W.137,5 L=590 FINGER SAF. SHAPE RAW

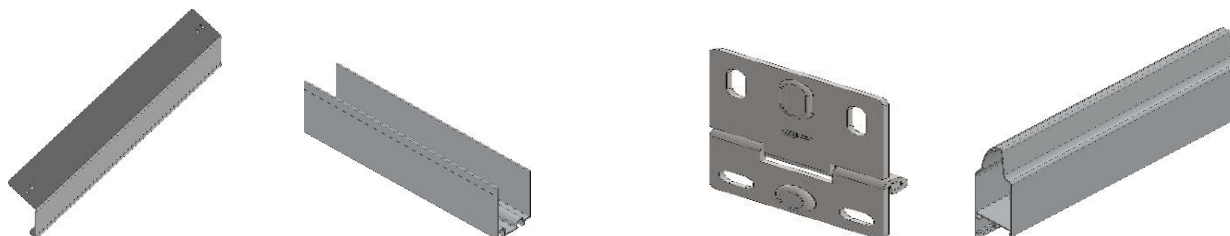

TECSEDO® PANELS - HARDWARE COMPONENTS BY

End Cap TECSEDO®BASE Micro

- **53.1P** END CAP DRILLED W.76 L=480 STRAIGHT RAL9010
- **53.10P** END CAP DRILLED W.76 L=590 STRAIGHT RAL9010
- **53.1Z** END CAP DRILLED W.76 L=480 STRAIGHT GALVANIZED
- **53.10Z** END CAP DRILLED W.76 L=590 STRAIGHT GALVANIZED
- **53.20Z** END CAP DRILLED W.153 L=590 STRAIGHT GALVANIZED

Alu Vision TECSEDO®SAFE Micro

- **18.60N** ALUM. FINGERPROT. NOSE PROFILE FOR GO-VISION SECTIONS - RAW
- **18.63N** ALUM. FINGERPROT. NOSE PROFILE WITH REINFORC. FOR GO-VISION SECTIONS - RAW
- **18.65N** ALUM. FINGERPROT. FEMALE PROFILE FOR GO-VISION SECTIONS - RAW

Pass Door TECSEDO®SAFE Micro

- **GO.LOWER.1.90.RAL** Kit -GO LOWER - Lower Step - 1 Point - L900 - Pan. 500/600 - RAL Std
- **GO.LOWER.5.90.RAL** Kit -GO LOWER - Lower Step - 5 Points - L900 - Pan. 500/600 - RAL Std

Bottom Alu Profile

- **18.121VN** BOTTOM/TOP ALUM. PROFILE WITH GO-LOWER CONNECTION (LOW VERSION)
50X43X20 RAL9005

Alu Windows

- **GOBLO1.VBT** ALUMINIUM GOBLO' WINDOW 495x330 SEALED SCREEN - RAL9016/9016
- **GOBLO1.VNT** ALUMINIUM GOBLO' WINDOW 495x330 SEALED SCREEN - RAL9005/9016
- **GOBLO1.GDT** ALUMINIUM GOBLO' WINDOW 495x330 SEALED SCREEN - GOLDEN OAK/9016

